



#### 4/31 Tallara Parkway Narrabundah ACT

4 2 1

Experience the epitome of style and comfort in this meticulously designed single-level townhouse nestled in the highly sought-after Inner South. Boasting a north-facing orientation at the rear, this exceptional home spans 153 sqm of living space on a manageable 300-sqm block.

With the convenience of direct street frontage within a boutique complex of just 10 homes, this residence is a rare gem. It features two distinct living areas, catering effortlessly to both downsizers seeking space and families in need of room to grow.

Step into the heart of the home and discover a thoughtfully planned kitchen that beckons gatherings with family and friends. Adorned with sleek stone benchtops, premium Bosch appliances, generous fridge space, and abundant storage, it's a culinary enthusiast's dream.

**Price** : \$1,200,000  
**Building Size** : 153 sqm  
**Land Size** : 300 sqm  
**View** : <https://www.borisproperty.com.au/sale/act/inner-south/narrabundah/residential/townhouse/8070873>



**Lee-Anne Radstaak**  
0402219727



**Boris Teodorowych**  
0402219727

<https://www.borisproperty.com.au>

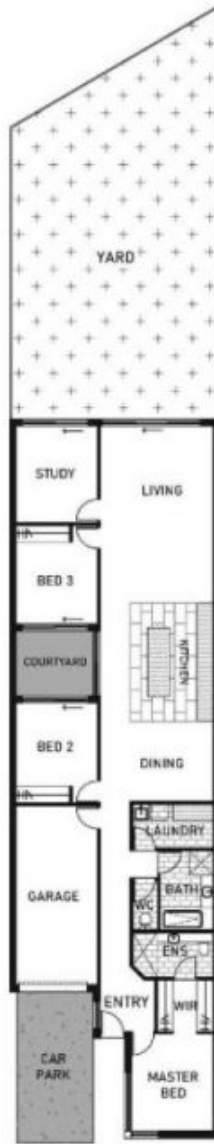

## 4/31 Tallara Parkway, Narrabundah

All information contained herein is gathered from a source we deem reliable. However we cannot guarantee its accuracy and interested parties should rely on their own enquiries.

**BORIS.**